

UPS battery replacement instruction

C6025 industrial pc with CU8130-0120 UPS component

All Beckhoff control units are equipped with a UPS to ensure the proper shutdown of the control IPC. However, this only works if the battery is in perfect condition to prevent data loss and ensure the flawless operation of the control system. The battery module for the UPS must be replaced **every 5 years**.

To order a new battery please contact spares.canman@soudronic.com.
Battery type C9900-U015 Order number 028638

Replacing the battery module

The battery module can be replaced directly in the control cabinet and without removing the DIN rail.

Requirements:

- T20 TORX screwdriver.
- C9900-U015 replacement battery module with 15 Wh.

Replace the battery as follows:

1. Switch off the main power of machine.
2. Wait until the IPC has shut down completely.
3. Unscrew the two T20 screws and pull the battery module out of the UPS.

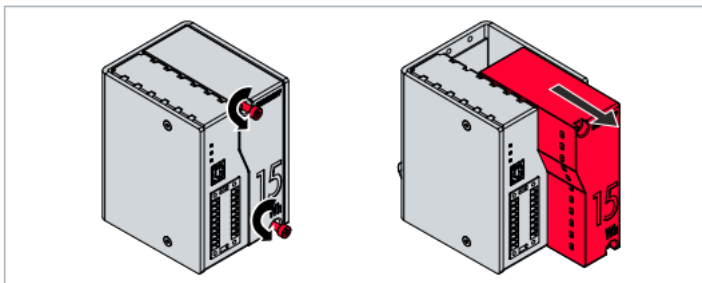

4. Push the replacement battery module into the UPS until the contacts click into place.

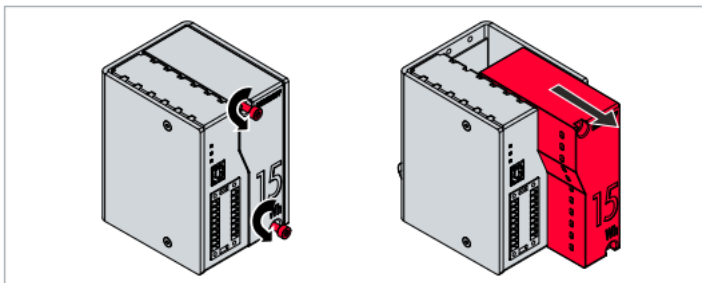

5. Fasten the battery module with two T20 screws and a torque of 0.7 Nm.

⇒ You have installed the battery module correctly if the DIAG LED lights up green at the start.